

6 5 4 3 2 1

D

D

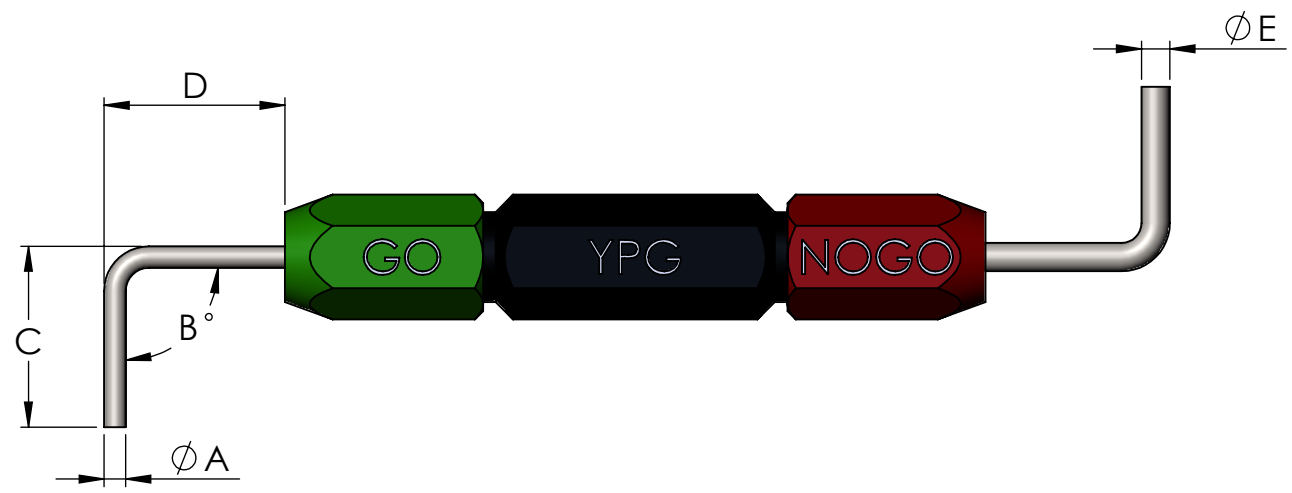

C

C

A (GO pin dia)	B (Bend angle)	C (Protrusion after bend)	D (Protrusion before bend)	E (NOGO pin dia)

B

B

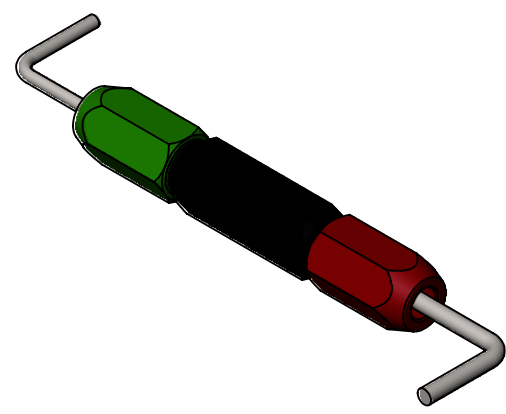

A

A

DIMENSIONS ARE IN MILLIMETERS		
	NAME	DATE
DRAWN	D.Fletcher	20/11/2019
TITLE: Angled/Bent Pin Plug Gauge		
MATERIAL: Tool Steel		

Yorkshire Precision Gauges
Hatfield
Doncaster
England
DN7 6QF

DWG. NO.
BPPG-001

SCALE: 1:1

**YORKSHIRE
PRECISION
GAUGES**

t: +44 (0)1302 840 303
f: +44 (0)1302 843 570
Gauges@ypg.co.uk
<http://www.ypg.co.uk/>

SHEET 1 OF 1

6 5 4 3 2 1